

REV.	LOCAS.	DESCRIPTION	DATE	DRAWN
01		INITIAL RELEASE.	2020.07.06	

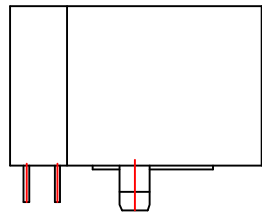

LEFT SIDE VIEW

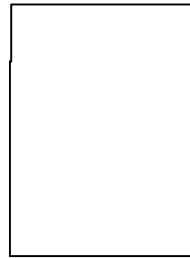

TOP VIEW

MATERIAL:

HOUSING: PA46,UL94V-0, BLACK.

TERMINAL: PHOSPHOR BRONZE Ø=0.46MM, G/FU" GOLD PLATING.

MACHANICAL:

DURABILITY: 750 CYCLES MIN,12.5MM/MINUTE.

INSERTION FORCE : 2.2KG.F MAX.

RETENTION STRENGTH : 7.7KG.F BETWEEN JACK AND PLUG .

OPERATING TEMPERATURE: -40 °C~+85°C.

STORAGE TEMPERATURE: -40°C~+85°C.

ALL CRITICAL DIMENSIONS WITH "*"

ELECTRICAL:

VOLTAGE: 125 VOLTS AC.

CURRENT RATING : 1.5AMP.

DIELECTRIC STRENGTH : 1000 VAC RMS 50HZ OR 60HZ,1 MIN.

INSULATION RESISTANCE: 500 MEGA OHMS MIN. INITIAL
AFTER 500V DC FOR 1 MINUTE.

CONTACT RESISTANCE: SINGLE TERMINAL 30 MILLIOHMS MAX.
INITIAL 50 MILLIOHMS MAX. AFTER
DURABILITY TEST.

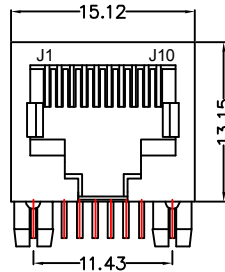

FRONT VIEW

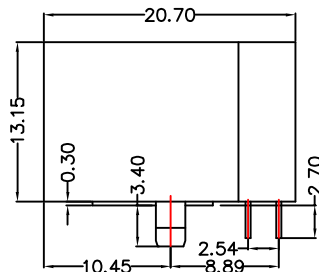

RIGHT SIDE VIEW

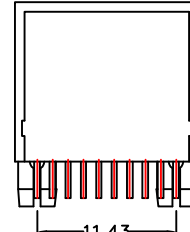

BACK VIEW

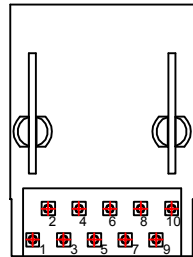

BOTTOM VIEW

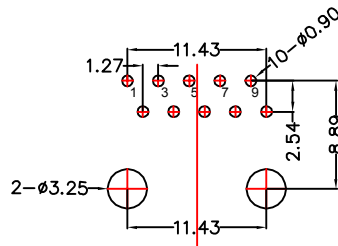

RECOMMENDED PCB LAYOUT
VIEWED FROM COMPONENT SIDE

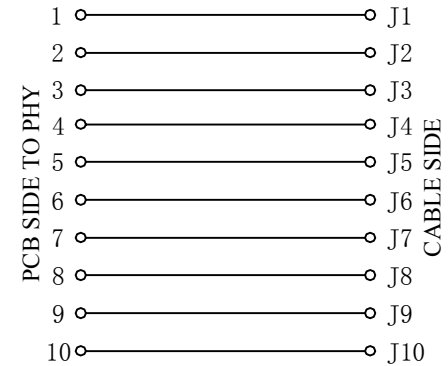

PART NO.	59211111IWA3DY1027	DRAWN	MARK
DWG NO.		CHECK	JOHN
TOLERANCE	X.±0.35 .X±0.30	APPROVE	MELODY

TITLE: RJ45 10P10C 1*1	REV. A0	.XX±0.25 .XXX±0.10	SCALE 1:1	UNIT mm	NO	DESCRIPTION
------------------------	---------	--------------------	-----------	---------	----	-------------