

IDC CONNECTOR DIP S-TYPE

5460 SERIES - 2.54MM



Specifications

- Rated current: 3.0AMP
- Contact resistance: 20mΩ max
- Withstand Voltage: 1000V AC/DC
- Insulation resistance: 1000MΩ min
- Operation temperature: -40°C to +105°C
- Contact material: Brass
- Contact plating: Au Or Sn Over Ni
- Insulator material: Polyester (UL94V-0)
- Standard: PBT
- Max. processing Temp: 180°C for 30-60 seconds
200°C for 10 seconds

Ordering Information

5460DS - XX X B X X 01

1 2 3 4 5 6

1. Connector Series
2. Number of pins (6→64P)
3. Contact plating
 - A = Gold Flash/Ni
 - B = Ni
4. Connecteur Type
 - B = Brass
5. Color type
 - B = Black
 - G = Grey
5. Option type
 - W = With Bump
 - Ø = Without Bump

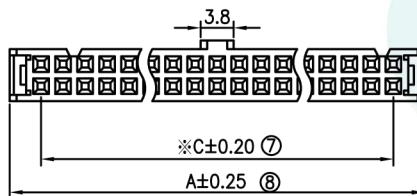
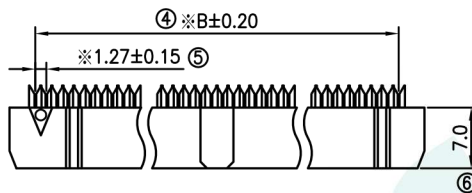
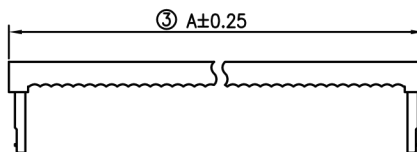
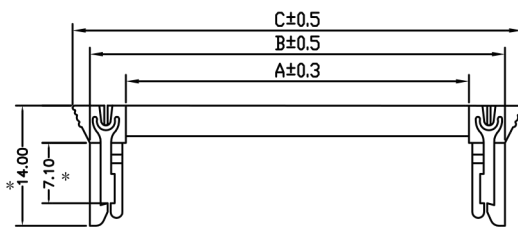

8P~64P

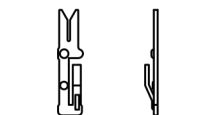
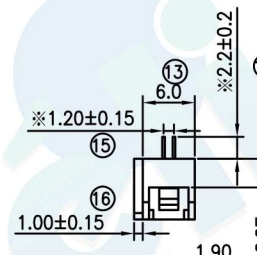
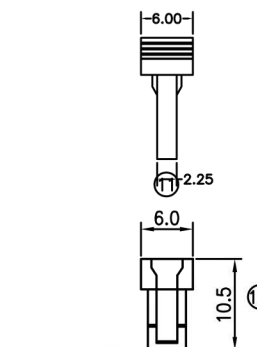

SINGLE CONTACT TYPE

Pos.	Dim. A	Dim. B	Dim. C
6	12.32	6.35	5.08
8	14.86	8.89	7.62
10	17.40	11.43	10.16
12	19.94	13.97	12.70
14	22.48	16.51	15.24
16	25.02	19.05	17.78
18	27.56	21.59	20.32
20	30.10	24.13	22.86
24	35.18	29.21	27.94
26	37.72	31.75	30.48
28	40.26	34.29	33.02
30	42.80	36.83	35.56
34	47.88	41.91	40.64
36	50.42	44.45	43.18
40	55.50	49.53	48.26
44	60.58	54.61	53.34
50	68.20	62.23	60.96
60	80.90	74.93	73.66
64	85.98	80.01	78.74

蝴蝶扣

POLES	DIM.A	DIM.B	DIM.C
6	8.02	17.00	21.40
8	10.56	19.54	23.94
10	13.10	22.08	26.48
12	15.64	24.62	29.02
14	18.18	27.16	31.56
16	20.72	29.70	34.10
18	23.26	32.24	36.64
20	25.80	34.78	39.18
24	30.88	39.86	44.26
26	33.42	42.40	46.80
30	38.50	47.48	51.88
34	43.58	52.56	56.96
40	51.20	60.18	64.58
50	63.9	72.88	77.28

			OPERATION		DRAW	BEN	12.04.18	SCALE	FIT	 votre partenaire en électronique	
			X.X	±0.30							
			X.XX	±0.20	CHECK			UNIT	mm	PART NO. 5460DS - XXXBXX 01	
			X.XXX	±0.10							
A0	2012.04.18	NEW DRAWING	Angle	±3°	APPROVE			SIZE	A4	TITLE: 2.54 IDC NPin	
REV	DATE	MODIFICATION DESCRIPTION	DIM	TOL							

IDC CONNECTOR DIP S-TYPE

5460 SERIES - 2.54MM



Specifications

- Rated current: 3.0AMP
- Contact resistance: 20mΩ max
- Withstand Voltage: 1000V AC/DC
- Insulation resistance: 1000MΩ min
- Operation temperature: -40°C to +105°C
- Contact material: Brass
- Contact plating: Au Or Sn Over Ni
- Insulator material: Polyester (UL94V-0)
- Standard: PBT
- Max. processing Temp: 180°C for 30-60 seconds
200°C for 10 seconds

Ordering Information

5460DS - XX X B X X 02

1
2
3
4
5
6

1. Connector Series
2. Number of pins (6→64P)
3. Contact plating
 - A = Gold Flash/Ni
 - B = Ni
4. Connecteur Type
 - B = Brass
5. Color type
 - B = Black
 - G = Grey
5. Option type
 - W = With Bump
 - Ø = Without Bump

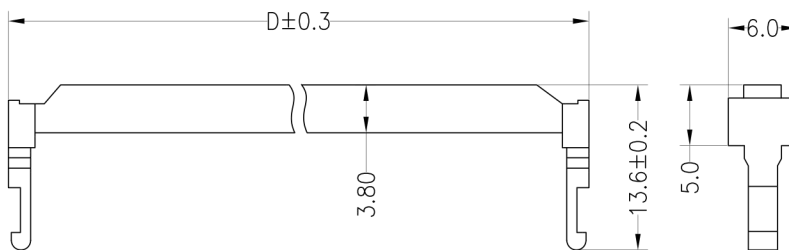

Strain relief P/N:G5315-XXDB01

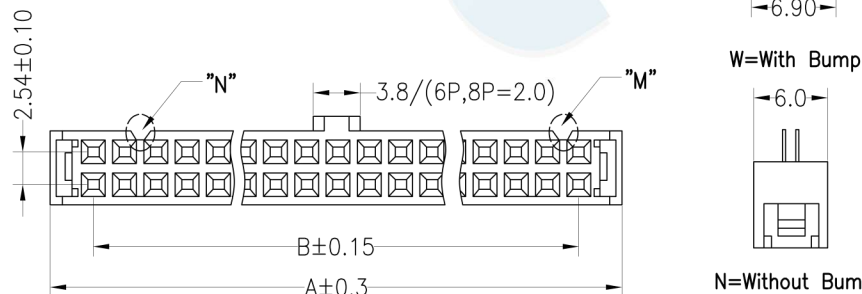
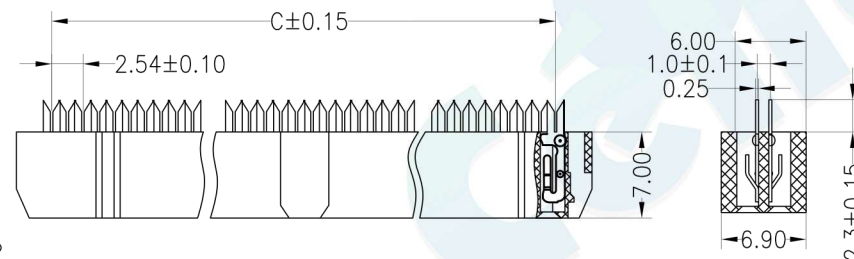
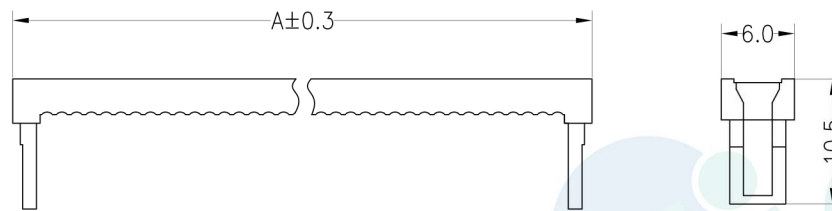

Pin	Dimension mm			
	A	B	C	D
06	12.42	5.08	6.35	12.12
08	14.96	7.62	8.89	14.66
10	17.50	10.16	11.43	17.20
12	20.04	12.70	13.97	19.74
14	22.58	15.24	16.51	22.28
16	25.12	17.78	19.05	24.82
18	27.66	20.32	21.59	27.36
20	30.20	22.86	24.13	29.90
24	35.28	27.94	29.21	34.98
26	37.82	30.48	31.75	37.52
28	40.36	33.02	34.29	40.06
30	42.90	35.56	36.83	42.60
34	47.98	40.64	41.91	47.68
40	55.60	48.26	49.53	55.30
44	60.68	53.34	54.61	60.38
50	68.30	60.96	62.23	68.00
60	81.00	73.66	74.93	80.70
64	86.08	78.74	80.01	85.78

				OPERATION		DRAW	BEN	12.04.18	SCALE	FIT	votre partenaire en électronique	
				X.X	±0.30							
				X.XX	±0.20	APPROVE			SIZE	A4	PART NO.	5460DS - XXXBXX 02
				X.XXX	±0.10							
A0	2012.04.18	NEW DRAWING		Angle	±3°	PROJ.	TITLE:	2.54 IDC NPin with strain relief clamp, single touching				
REV	DATE	MODIFICATION DESCRIPTION		DIM	TOL							