

IDC CONNECTOR DIP TYPE

5440 SERIES - 1.27MM



Specifications

- Rated current: 1.0AMP
- Contact resistance: 30Ω max
- Withstand Voltage: 500V AC/DC
- Insulation resistance: 1000MΩ min
- Operation temperature: -40°C to +105°C
- Contact material: Phosphore Bronze
- Contact plating: Sn Over Ni
- Insulator material: LCP Polyester (UL94V-0)
- Cover material: PBT Polyester (UL94V-0)
- Max. processing Temp: 180°C for 30-60 seconds
200°C for 10 seconds

Ordering Information

5440D - XX A P B 02

1
2
3
4
5

- 1. Connector Series**
- 2. Number of pins (10→100P)**
- 3. Contact plating**
 - A = Tin
 - B = Matte Tin
- 4. Connecteur Type**
 - P = Phosphore bronze
- 5. Color type**
 - B = Black



Recommended P.C.B Layout (Top Side)
(PCB BOARD TOLERANCE ±0.05)

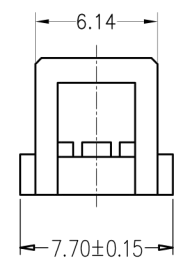
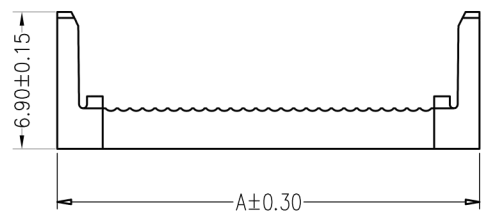
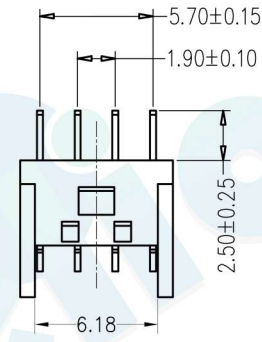
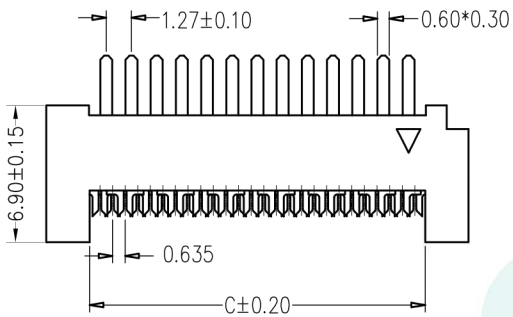
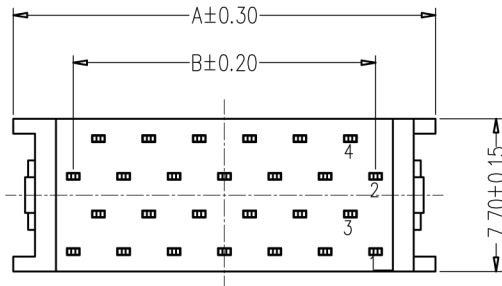
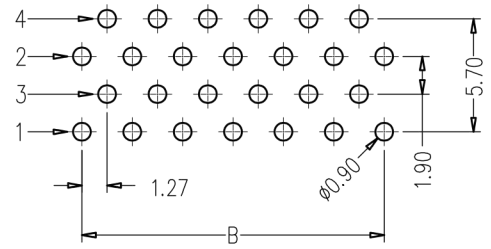

PIN NO.	A	B	C
10	11.13	5.08	6.76
20	17.48	11.43	13.11
26	21.29	15.24	16.92
30	23.83	17.78	19.46
40	30.18	24.13	25.81
50	36.53	30.48	32.16
60	42.88	36.83	38.51
68	47.96	41.91	43.59
70	49.23	43.18	44.86
72	50.50	44.45	46.13
80	55.58	49.53	51.21
90	61.93	55.88	57.56
100	68.28	62.23	63.91

				OPERATION		DRAW	BEN	12.04.18	SCALE	FIT	votre partenaire en électronique PART NO. 5440D - XXXPA 02 TITLE: 1.27 FD NPin D-Type Matte-Tin Four Row Foot		
				X.X	±0.30				UNIT	mm			
				X.XX	±0.20	CHECK	SIZE	A4					
				X.XXX	±0.10	APPROVE	SHEET	1/1					
A0	2012.04.18	NEW DRAWING		Angle	±3°			PROJ.	◆				
REV	DATE	MODIFICATION DESCRIPTION		DIM	TOL								