

IDC CONNECTOR DIP Y-TYPE

5420 SERIES - 2.00MM



Specifications

- Rated current: 1.0AMP
- Contact resistance: 20Ω max
- Withstand Voltage: 500V AC/Min
- Insulation resistance: 1000MΩ min
- Operation temperature: -40°C to +105°C
- Contact material: Brass
- Contact plating: Au Or Sn Over Ni
- Insulator material: Polyester (UL94V-0)
- Standard: PBT
- Max. processing Temp: 180°C for 30-60 seconds
200°C for 10 seconds

Ordering Information

5420DY - XX X B B X

1
2
3
4

1. Connector Series

2. Number of pins (6→80P)

3. Contact plating

- A=Gold Flash/Ni
- B =3U" Gold/Ni
- C=5U" Gold/Ni
- D=10U" Gold/Ni
- E= 20U" Gold/Ni
- F= 30U" Gold/Ni
- G=Ni

4. Option Type

- W = With Bump
- Ø = Without Bump

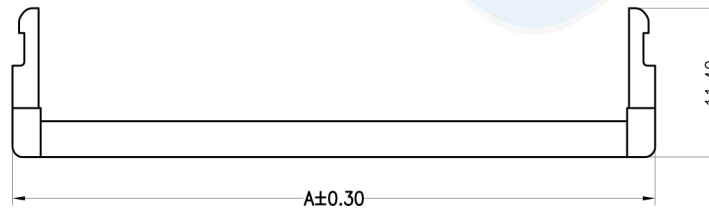
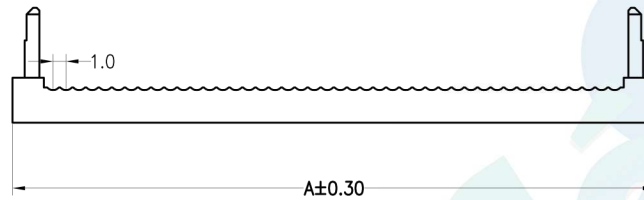
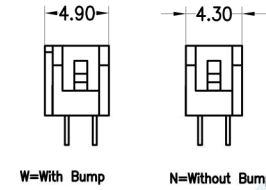
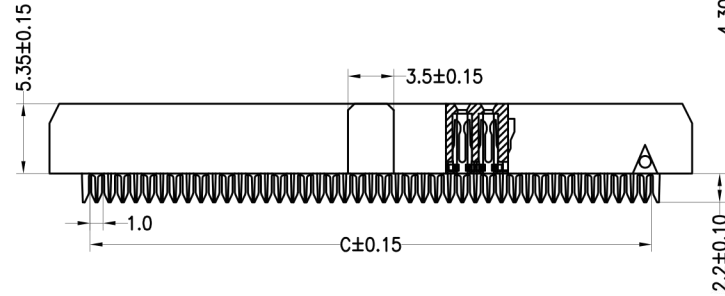
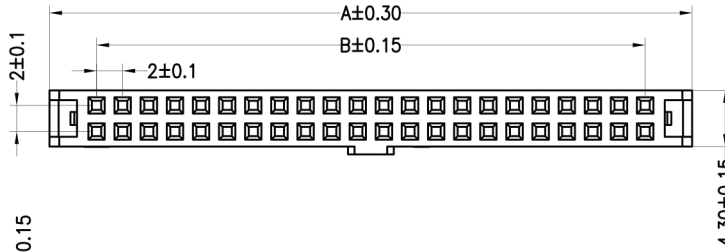

Strain Reliefe

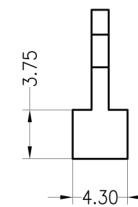
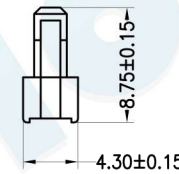

Pin	Dimension mm		
	A	B	C
06	11.20	4.00	5.00
08	13.20	6.00	7.00
10	15.20	8.00	9.00
12	17.20	10.00	11.00
14	19.20	12.00	13.00
16	21.20	14.00	15.00
18	23.20	16.00	17.00
20	25.20	18.00	19.00
24	29.20	22.00	23.00
26	31.20	24.00	25.00
30	35.20	28.00	29.00
34	39.20	32.00	33.00
40	45.20	38.00	39.00
44	49.20	42.00	43.00
50	55.20	48.00	49.00
60	65.20	58.00	59.00
64	69.20	62.00	63.00
68	73.20	66.00	67.00
80	85.20	78.00	79.00

				OPERATION		DRAW	BEN	12.04.18	SCALE	FIT	 votre partenaire en électronique		
				X.X	±0.30				UNIT	mm			
				X.XX	±0.20	CHECK		SIZE	A4	PART NO.			5420DY - XXXBBX
				X.XXX	±0.10	APPROVE		SHEET	1/1	TITLE:			2.00 FC(IDC) Y-Type NPin
REV	DATE	MODIFICATION DESCRIPTION	CHANGE	DIM	TOL			PROJ.	◆				