

# FEMALE HEADER DIP RIGHT ANGLE SIDE ENTRY

## 22 SERIES - 2.54MM PITCH



Recommended P.C.B Layout (Top Side)  
(PCB BOARD TOLERANCE ±0.05)

### Specifications

- Rated Current: 3.0AMP
- Contact Resistance: 20mΩ Max
- Withstand Resistance: 1000V AC/DC
- Insulation Resistance: 1000MΩ Min
- Operation Temperature: -40°C to +105°C
- Contact Material: Brass
- Contact Plating : Au Or Sn Over Ni
- Insulator Material : Polyester (UL94V-0)
- Standard : PA6T
- Max. Processing Temp : 230° for 30-60 seconds  
260° for 10 seconds

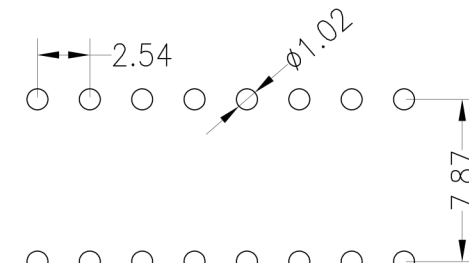

### Ordering Information

**2281DR - 1 U (XX) - A B C (1)**

1 2
3 4
5 6 7

#### 1. Connector Series

#### 2. (H) Hauteur isolant

- H = 81 (Hauteur isolant : 8.1mm)

#### 3. U-Type

#### 4. Number of pins per row

#### 5. Insulator Material Option

- A = BK-PBT
- B = BK-PA66
- C = BK-PA6T
- D = BK-PA46
- E = BK-LCP

#### 6. Contact Plating

- A = Gold Flash
- B = 3U" Gold
- C = 5U" Gold
- D = 10U" Gold
- E = 15U" Gold
- F = 30U" Gold
- G = Gold Flash/Tin
- H = Tin

#### 7. Post

- W (With Post)
- Ø (No Post)

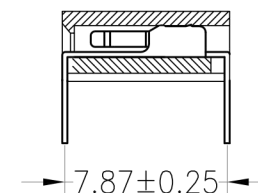
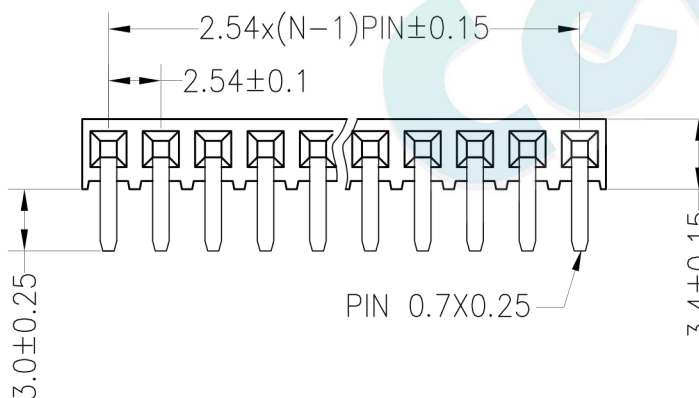
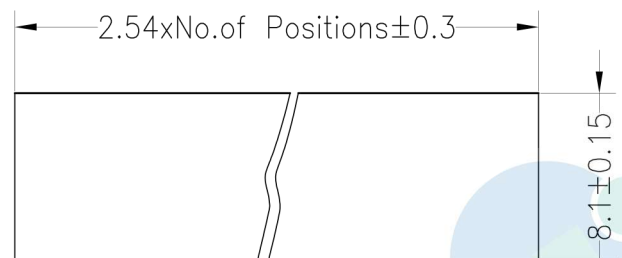
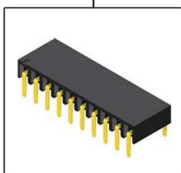

#### (1). Packaging

Ø=PE Bag 1=Tray 2=Tube 3=Tube+Cap

				OPERATION		DRAW	BEN	12.04.18	SCALE	FIT	votre partenaire en électronique	
				X.X	±0.30				UNIT	mm		
				X.XX	±0.20	CHECK		SIZE	A4	PART NO.	2281DR - 1UXX - XXX	
				X.XXX	±0.10		APPROVE		SHEET	1/1	TITLE:	2.54PF H8.1*W3.4mm 1xNpin 90° Side Entry
REV	DATE	MODIFICATION DESCRIPTION	CHANGE	DIM	TOL			PROJ.				