

PIN HEADER SMT SINGLE ROW

13 SERIES. 2.00MM PITCH



Specifications

- Rated Current: 1.5AMP
- Contact Resistance: 20mΩ Max
- Withstand Resistance: 500V AC/DC
- Insulation Resistance: 1000MΩ Min
- Operation Temperature: -40°C to +105°C
- Contact Material: Brass
- Contact Plating : Au Or Sn Over Ni
- Insulator Material : Polyester (UL94V-0)
- Standard : PA6T
- Max. Processing Temp : 230° for 30-60 seconds
260° for 5 seconds

Ordering Information

1315S - 11 (XX) - AAA - B C P (1)

1. Connector Series

2. (H) Hauteur isolant

- H = 15 (Hauteur isolant : 1.5mm)

3. Number of pins per row

4. Pin Length

5. Insulator Material Option

- A = BK-PBT
- B = BK-PA66
- C = BK-PA6T
- D = BK-PA46
- E = BK-LCP

6. Contact Plating

- A = Gold Flash
- B = 3U" Gold
- C = 5U" Gold
- D = 10U" Gold
- E = 15U" Gold
- F = 30U" Gold
- G = Gold Flash/Tin
- H = Tin

7. Post

- W (With Post)
- Ø (No Post)

(1). Packaging

Ø = PE Bag 1= Tray 2= Tube+Cap 3= Tube+Cap 4= Reel+Tape

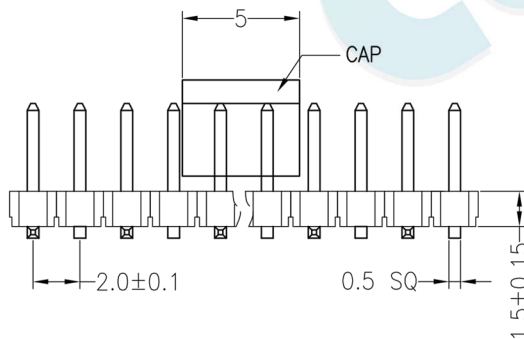
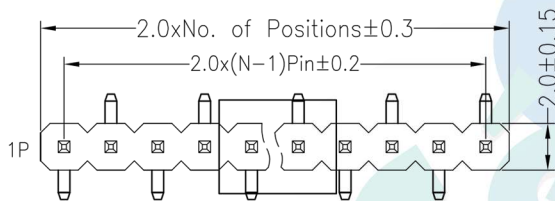
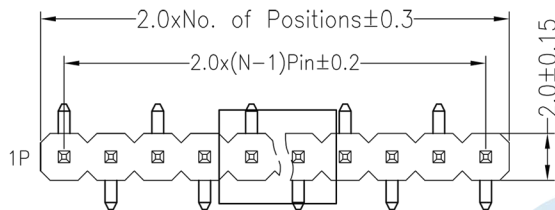
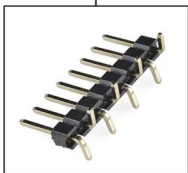

Recommended P.C.B Layout(Top Side)
(PCB BOARD TOLERANCE±0.05)

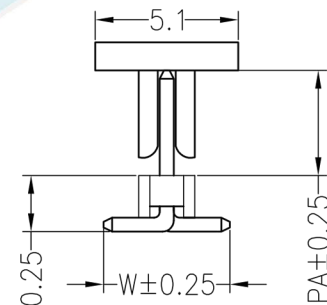
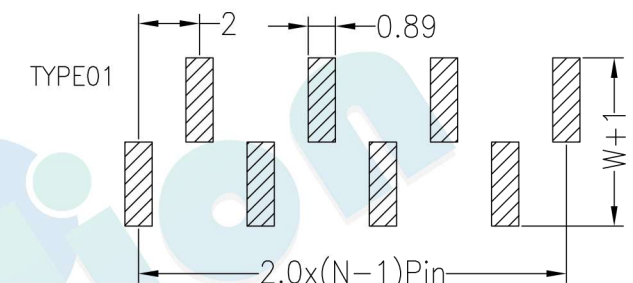
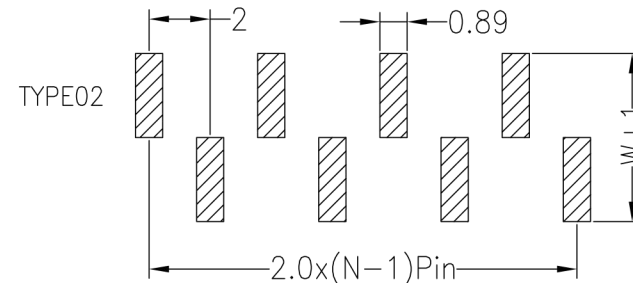

Dimension antitheses list				
ITEM	PA	PB	W	L
Standard	4.00	2.10	4.50	7.80
Alternate				

OPERATION	DRAW	YiYuSheng	13.03.28	SCALE	FIT
X.X ±0.30	CHECK			UNIT	mm
X.XX ±0.20				SIZE	A4
X.XXX ±0.10				SHEET	1/1
Angle ±3°	APPROVE			PROJ.	◆
DIM TOL					



A0	2013.03.28	NEW DRAWING							
REV	DATE	MODIFICATION DESCRIPTION	CHANGE						

PART NO.	1315S - 11XX - XXX - XXX (1)
TITLE:	2.0PH 1xNpin H1.5mm SMT

PIN HEADER SMT SINGLE ROW

13 SERIES. 2.00MM PITCH



Specifications

- Rated Current: 1.5AMP
- Contact Resistance: 20mΩ Max
- Withstand Resistance: 500V AC/DC
- Insulation Resistance: 1000MΩ Min
- Operation Temperature: -40°C to +105°C
- Contact Material: Brass
- Contact Plating : Au Or Sn Over Ni
- Insulator Material : Polyester (UL94V-0)
- Standard : PA6T
- Max. Processing Temp : 230° for 30-60 seconds
260° for 5 seconds

Ordering Information

1320S - 11 (XX) - AAA - B C P (1)

1. Connector Series

2. (H) Hauteur isolant

- H = 20 (Hauteur isolant : 2.0mm)

3. Number of pins per row

4. Pin Length

5. Insulator Material Option

- A = BK-PBT
- B = BK-PA66
- C = BK-PA6T
- D = BK-PA46
- E = BK-LCP

6. Contact Plating

- A = 0.8U" Gold
- B = 1U" Gold
- C = 1.5U" Gold
- D = 2U" Gold
- E = 3U" Gold
- F = Gold Flash/Tin
- H = Tin

7. Post

- W (With Post)
- Ø (No Post)

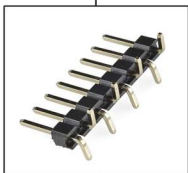

(1). Packaging

Ø = PE Bag 1=Tray 2=Tube 3=Pe 4= Tape&Reel 5=Tube&Reel

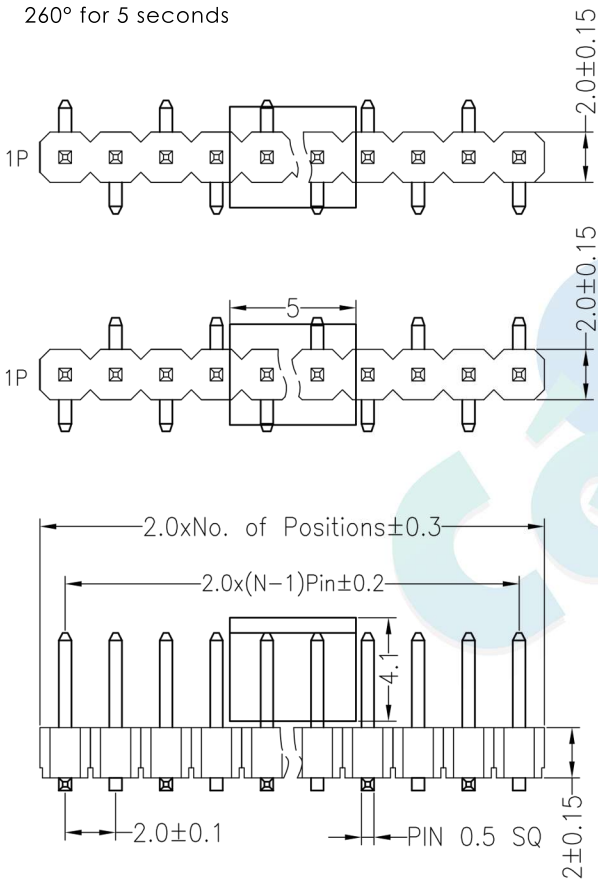

Recommended P.C.B Layout (Top Side)
(PCB BOARD TOLERANCE ± 0.05)

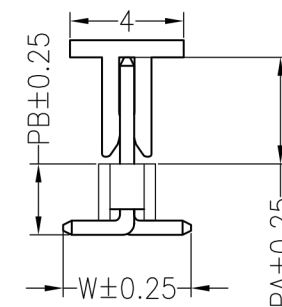
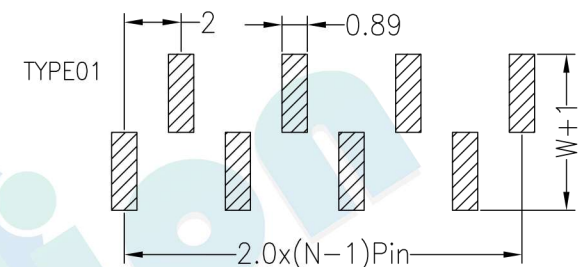
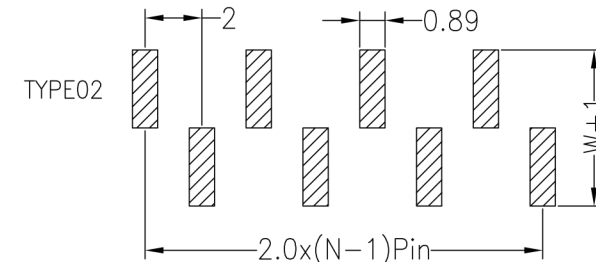

Dimension antitheses list				
ITEM	PA	PB	W	L
Standard	3.80	2.50	4.50	8.00
Alternate				

OPERATION

X.X	± 0.30
X.XX	± 0.20
X.XXX	± 0.10
Angle	$\pm 3^\circ$
DIM	TOL

DRAW

YiYuSheng

13.03.28

SCALE

FIT

UNIT

mm

SIZE

A4

SHEET

1/1

PROJ.

◆

CHECK

APPROVE



votre partenaire en électronique

PART NO.

1320S - 11XX - XXX - XXX

TITLE:

2.0PH 1xNpin H2.0mm SMT

A0

2013.03.28

NEW DRAWING

REV

DATE

MODIFICATION DESCRIPTION

CHANGE

5

6

7

8

9